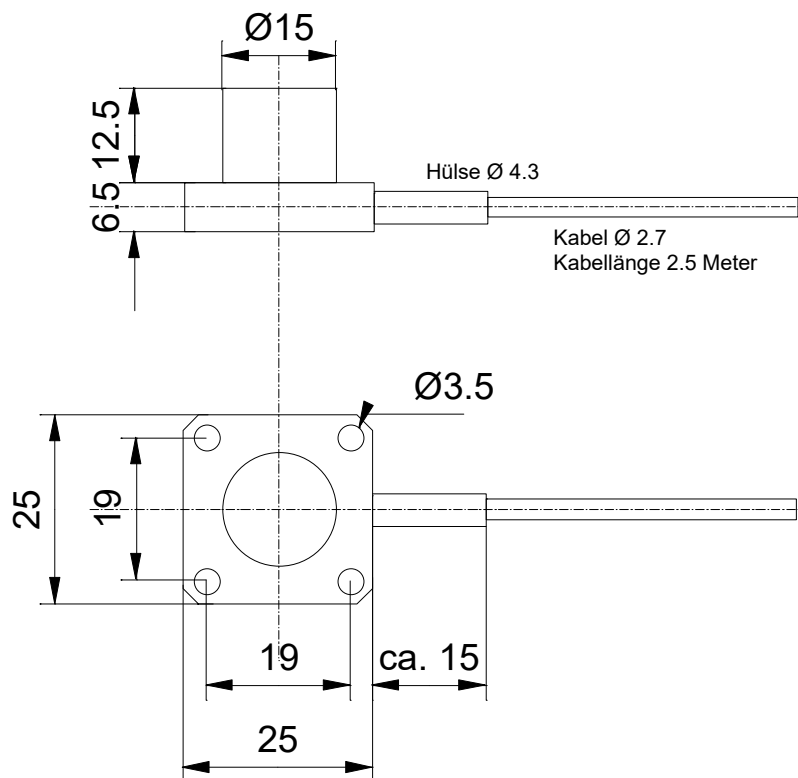

**AE100.942.025.G
Accelerometer**

Sensitivity: 100 mV/g
Supply: constant current 4 mA
Body material: stainless steel
Cable: 2-wire shielded, isolation of wires: PVC, outer isolation PUR
diameter of conductors 0,09 mm²; outer diameter approx. 2.7 mm,
length 2.5 meters, open cable end

Dimensions:

**Cable connections:**

white: signal
brown: ground
shield is isolated from body

Release: 07.06.2013

IBIS GmbH

Werner-von-Siemens-
Str. 21
64319 Pfungstadt

Tel: (0)6157-949-370

Fax: (0)6157-949-100

www.ibis-gmbh.deinfo@ibis-gmbh.de